



The Proven Performer in Laundry



SPEED QUEEN® LAUNDROMAT & MULTI-HOUSING LAUNDRY SOLUTIONS Stacked Washer-Extractor/Tumble Dryers

SST30

2x30 lb (14 kg)

SST50

2x50 lb (23 kg)

Reimagine Resident Satisfaction

Speed Queen's stacked washer-extractor/tumble dryer is the perfect machine to deliver maximum capacity in a small space, increasing your return on investment per square meter.

- Designed to produce maximum ROI per square foot for laundry rooms where space is at a premium
- Offers all the benefits of a Speed Queen 30-pound washer-extractor and tumble dryer (50-pound version also available)
- A flush-mounted soap dispenser contributes to the machine's sleek, modern design, that includes stainless steel with chrome accents
- Minimal front fasteners gives quick access to key washer-extractor components to improve serviceability
- Tumble dryer features two cycle modifiers for additional profit potential
- Enhance common laundry space with a larger capacity option and increase revenue opportunities, while leaving plenty of room for smaller machines.
- This Quantum Touch unit has the flexibility to offer a variety of vend options:
 - Electronic Single Slot Coin Drop
 - Mount a single Card Vend Terminal on each pocket
 - Connect with Insights PRO to have Cash less Smart Phone App interface



Stacked Washer-Extractor/Tumble Dryers

Quantum® Touch Control

Reimagine your laundry experience with the Speed Queen Quantum Touch display. Clear, easy to use, easy to understand directions with profitable cycle modifiers enhance your residents' experience.

- User-friendly screens with operating instructions built in as part of the control
- Washer-Extractor:
 - 15 total cycle options, 3 basic cycles, 1 custom cycle, 3 basic temperature options
- Tumble Dryer:
 - 5 basic cycles (high, medium, low, delicate, no heat)
- Easy-to-understand cycle modifier prompts will encourage your residents to customize their cycles
- Flexible pricing and additional revenue opportunities with customizable cycle modifiers, time-of-day pricing and lucky cycle options
- 30+ languages available
- On-screen timer so your residents know exactly how much time their cycle will take
- Speed Cycle option for those who want to get in and out quickly
- Flexible Payment Options - Coin, Card, Mobile, Cash

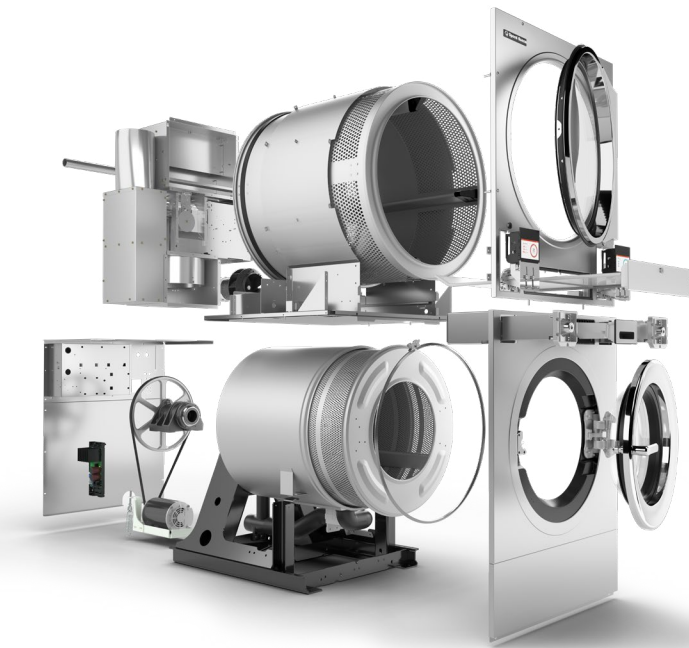

SPEED QUEEN®
INSIGHTS
READY

Take your business to new levels of efficiency and profitability with advanced analytics and resident use data—all integrated into the same platform with the rest of your business management tools. Know how often each resident visits, which machines they use, how they pay, and use that information to increase your revenue through stronger resident relationships and a more rewarding laundry experience.



SPEED QUEEN®
INSIGHTS
READY

A profitable Vended Laundry business relies on a combination of factors to grow and stay strong in a competitive market.

Primary factors of - Location - Size of store - Demographics - store layout - functionality and Equipment selection are the foundation of a strong business. But when you want to stand out from the market you need Speed Queen Touch

When you fully set up with the Speed Queen Insights PRO module, you will find a new level of flexibility in with the rest of your business management tools.

You can trust Speed Queens Global Heritage of design and strength, this is now enhanced by the largest cloud based network of Laundromat equipment spread across the Globe. Our USA based 24hr support team has the depth of know how to work with you locally to maximise returns.

You will have the flexibility and control over key aspects of your modern business

- Full visibility of all Washers and Dryers across your stores
- Remote commands - Start - Stop - Clear Vend etc
- Summary view of equipment use and income
- Set up management Alerts and Reports on key metrics
- Market your Cashless APP program directly to users
- CRM data collection - Rewards Programs - Bonus Offers
- Adjust programmed cycle via the cloud and much more.

Your confidence will continue to grow with the consistent evolution of this Global Network, all updated automatically.



Stacked Washer-Extractor/Tumble Dryers

		SST30		SST50	
		Washer-Extractor	Tumble Dryer	Washer-Extractor	Tumble Dryer
Control Option		Quantum Touch		Quantum Touch	
Capacity - lb (kg)		30 (14) x 2		50 (23) x 2	
Overall Width - (mm)		(797)		(875)	
Overall Depth - (mm)		(1152)		(1302)	
Overall Height - (mm)		(2023)		(2141)	
Cylinder Diameter - (mm)		(610)	(762)	(668)	(838)
Cylinder Depth - (mm)		(406)	(660)	(515)	(762)
Cylinder Volume - (liters)		(119)	(300)	(178)	(419)
Reversing Cylinder		-	Standard	-	Standard
Door Opening Size - (mm)		(363)	(574)	(414)	(683)
Door Bottom to Floor - (mm)		(356)	(1303)	(370)	(1328)
Water Inlet Connection - (mm)		2 x (19)	-	2 x (19)	-
Drain Diameter - (mm)		1 x (76)	-	1 x (76)	-
Drain Height to Floor - (mm)		(108)	-	(115)	-
Heat Input Power - Btu/hr (kW, Mj/hr.)		-	73,000 (21.4, 77.0)	-	95,000 (27.8, 100)
Gas Connection - in		-	1/2 NPT	-	1/2 NPT
Air Outlet - (mm)		-	(200) Elliptical	-	(250) Elliptical
Airflow - cfm (l/sec)		-	400 (190)	-	600 (285)
Motor - HP (kW)		Fan	0.5 (0.4)	-	0.5 (0.4)
		Drive	0.3 (0.2)	2 (1.5)	0.5 (0.4)
Total # of Speeds		9		9	
Cylinder Speeds - RPM (G-Force)		Gentle	34 (0.4)	-	33 (0.4)
		Wash	48 (0.8)	-	46 (0.8)
		Distribution	86 (2.5)	-	82 (2.5)
		Very Low	282 (27)	-	269 (27)
		Low	485 (80)	-	464 (80)
		Medium	542 (100)	-	518 (100)
		High	606 (125)	-	579 (125)
		Very High	664 (150)	-	635 (150)
		Ultra High	766 (200)	-	733 (200)
Electrical Specs - amps		200-240V/50/1/3	15	10	15
					10
Shipping Dimensions Approx. - (mm)		Width	(876)		(902)
		Depth	(1194)		(1372)
		Height	(2108)		(2261)
Net Weight - (kg)		(349)		(413)	
Shipping Weight - (kg)		(357)		(422)	

For the most accurate information, the installation guide should be used for all design and construction purposes. Due to continuous product improvements, design and specifications subject to change without notice. The quality management systems of Alliance Laundry Systems are registered to ISO 9001.

Andrew Barton Laundry Systems.
 67 Colebard Street West, Acacia Ridge
 QLD 4110
 Ph: +61 7 3716 1333
 Fax: +61 7 3716 1398
 W: www.andrewbarton.com.au
 E: info@andrewbarton.com.au
 Servicing Queensland

